

M 1996-K



MINIKIT

Proseguire nella pagina successiva per visualizzare la scheda tecnica dei componenti

Revisione	Prodotto
REV.00 10/04/2026	OEM

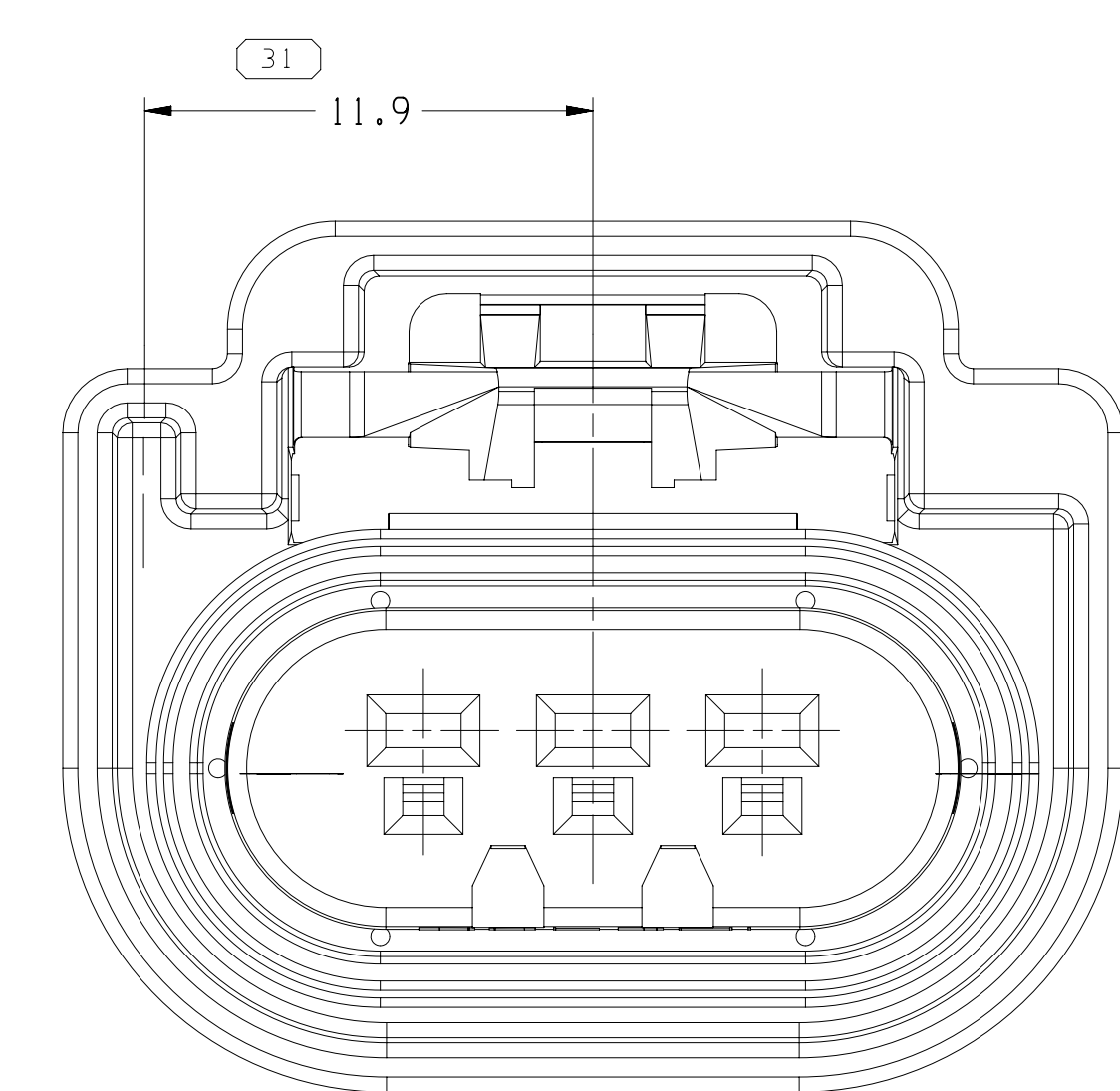

TYPE 110
SAME AS TYPE 101
EXCEPT AS SHOWN

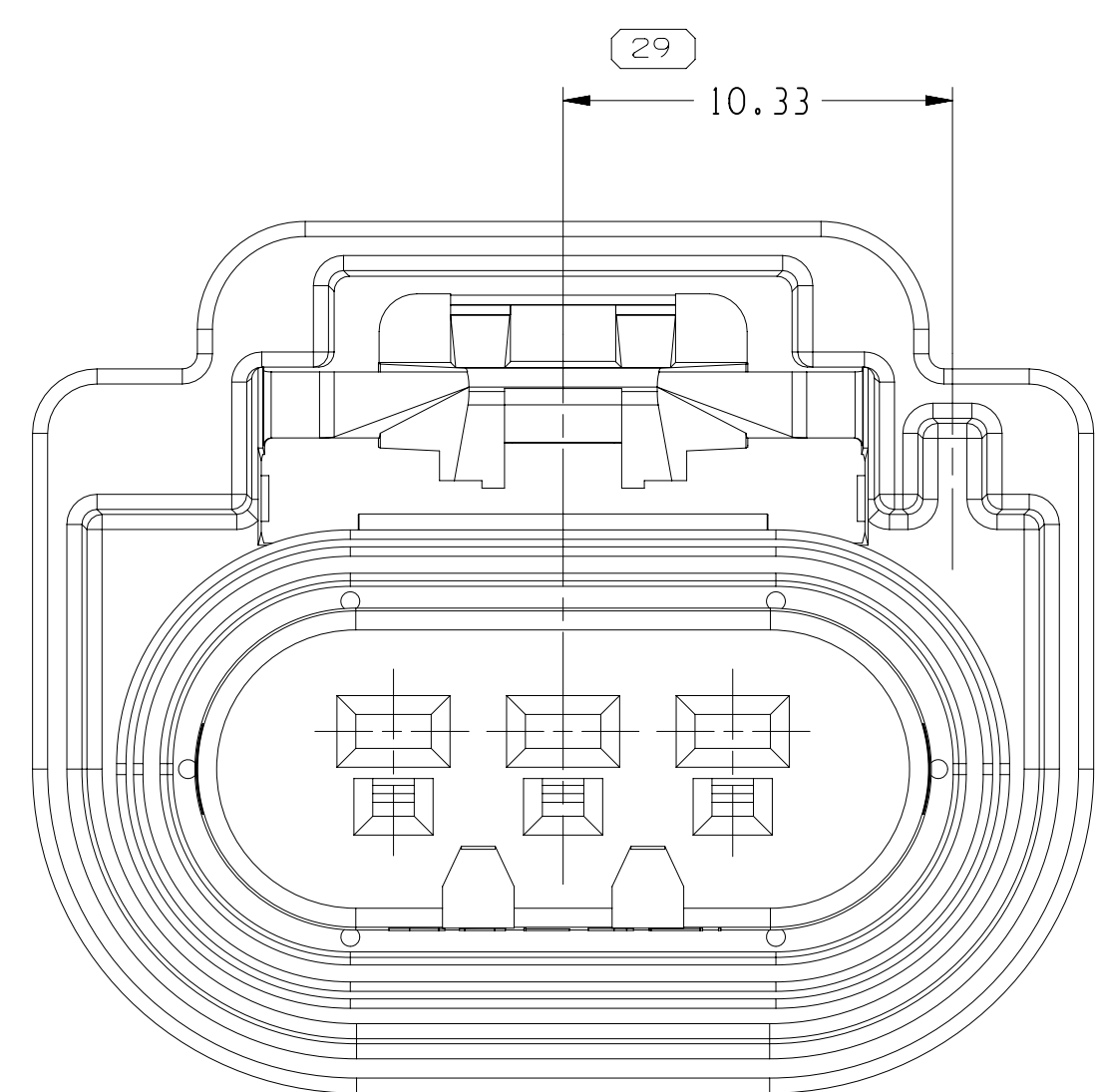

TYPE 107
SAME AS TYPE 102
EXCEPT AS SHOWN

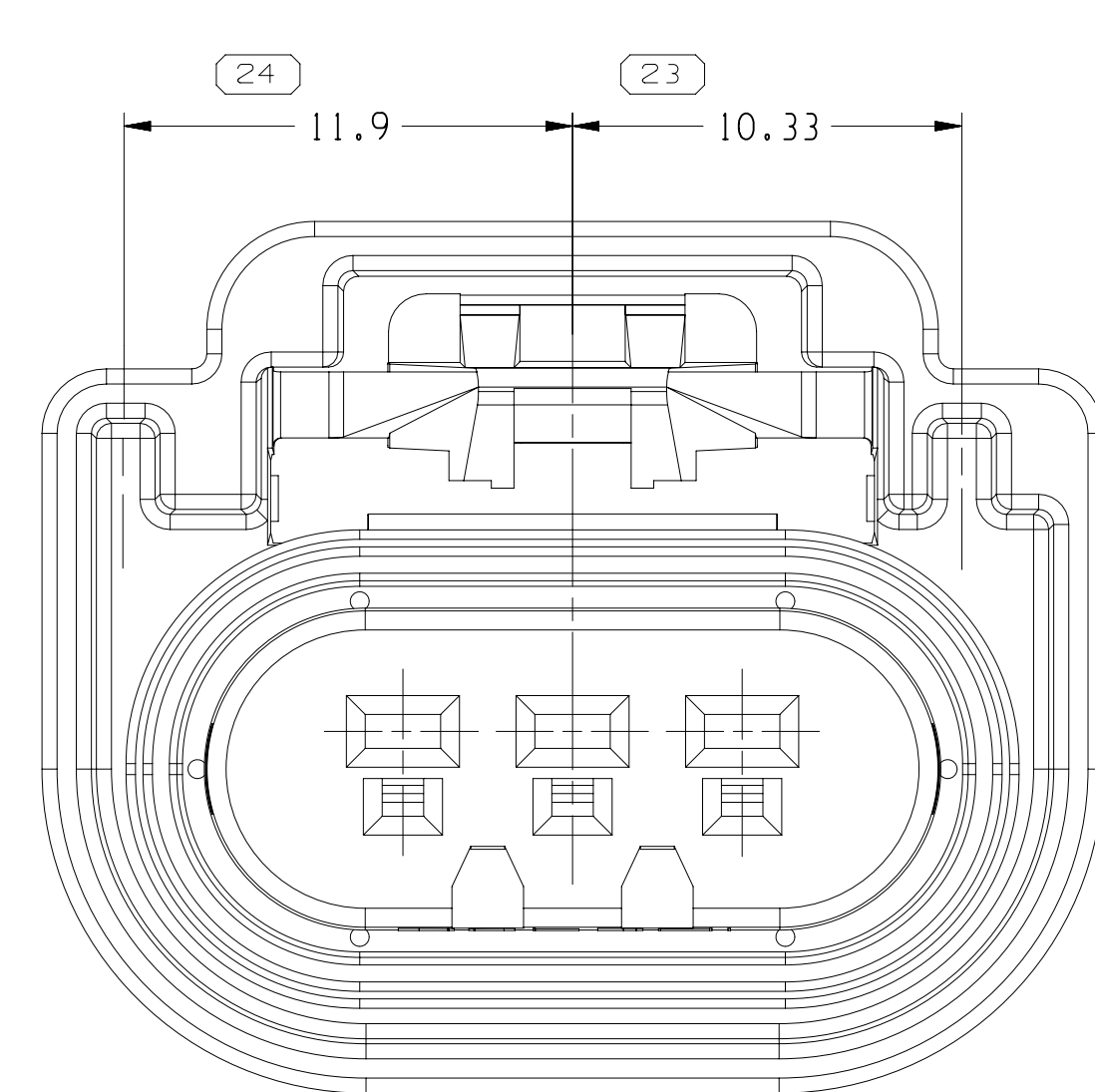

TYPE 104
SAME AS TYPE 102
EXCEPT AS SHOWN

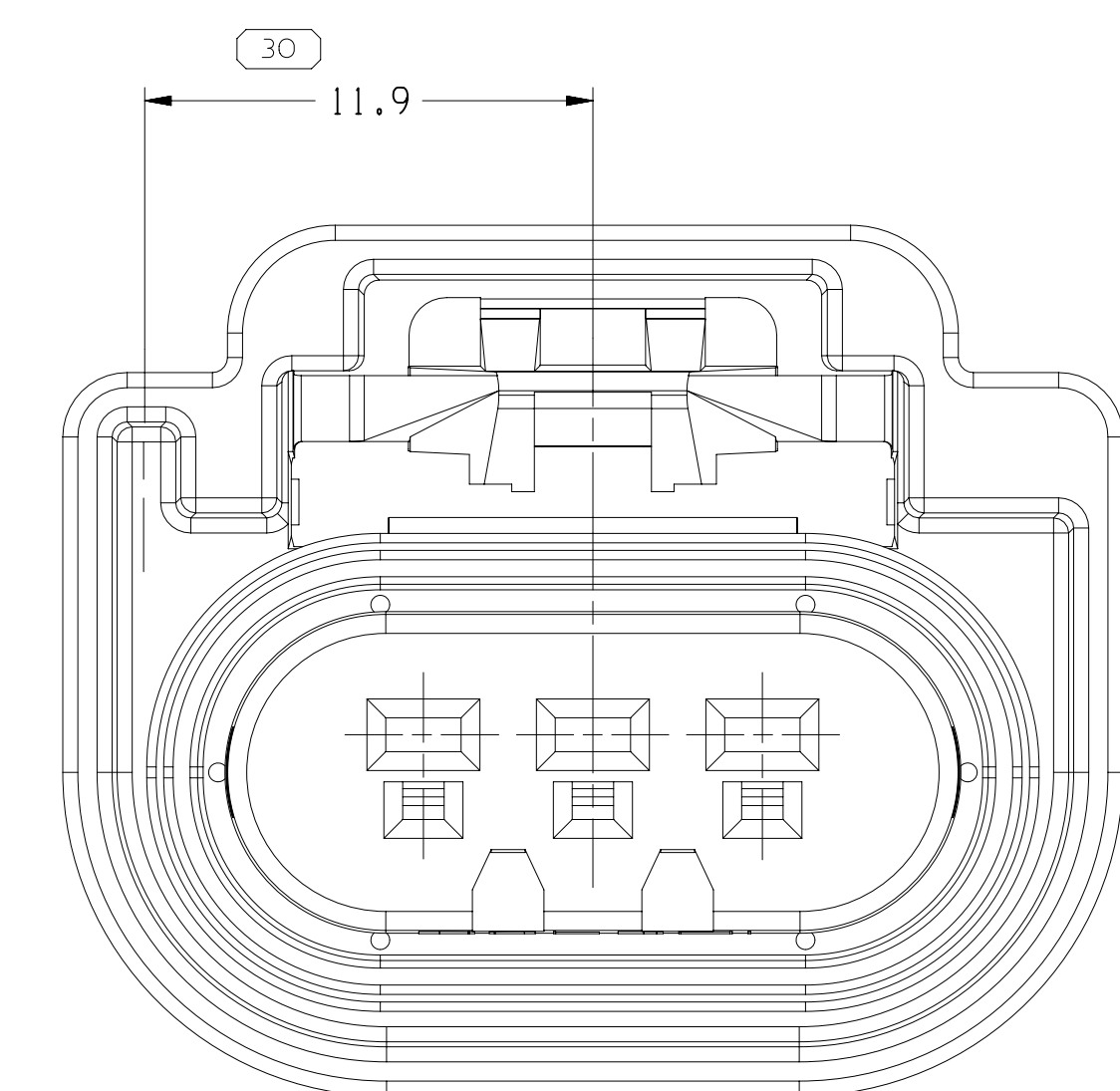

TYPE 109
SAME AS TYPE 102
EXCEPT AS SHOWN

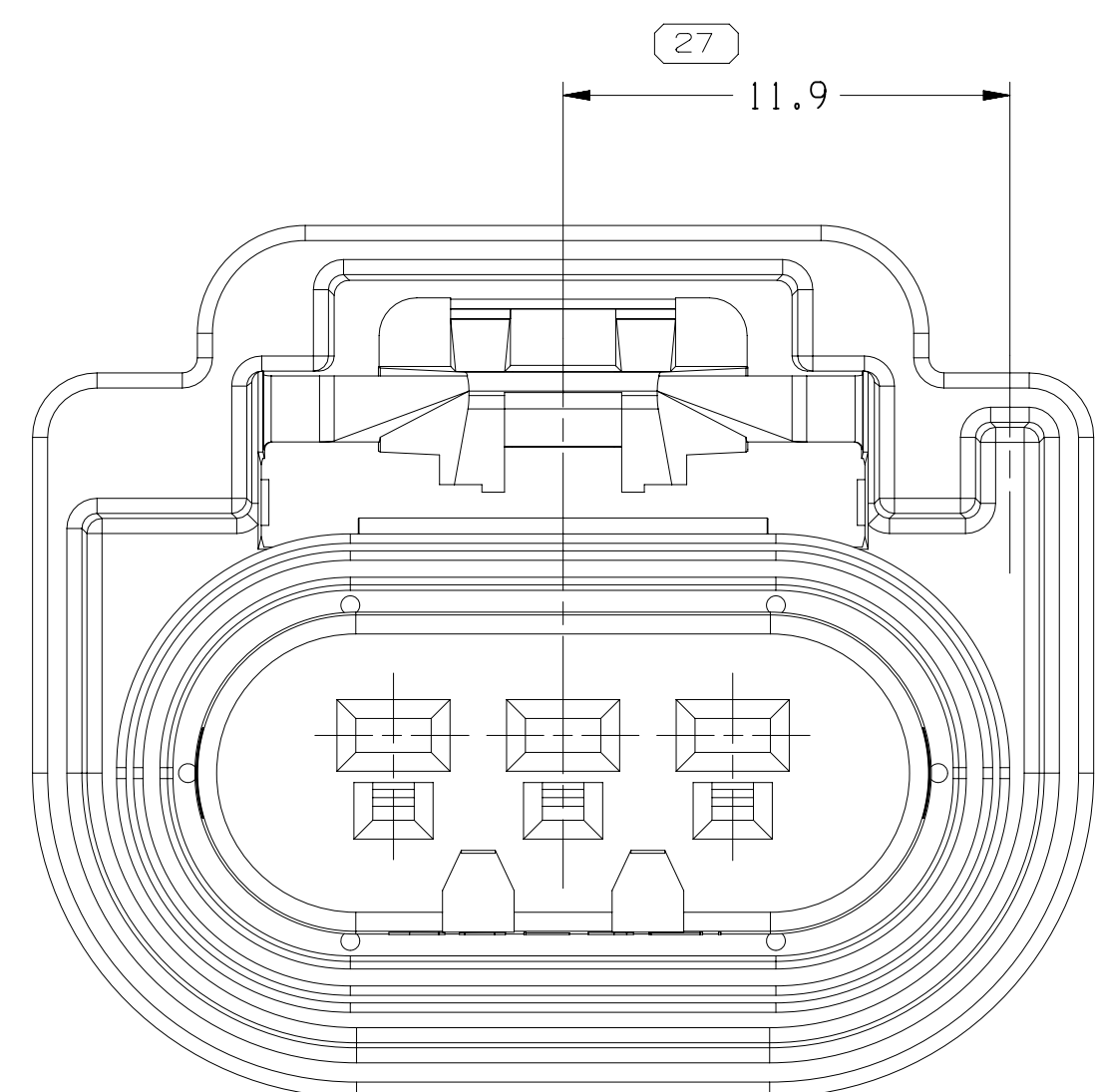

TYPE 106
SAME AS TYPE 102
EXCEPT AS SHOWN

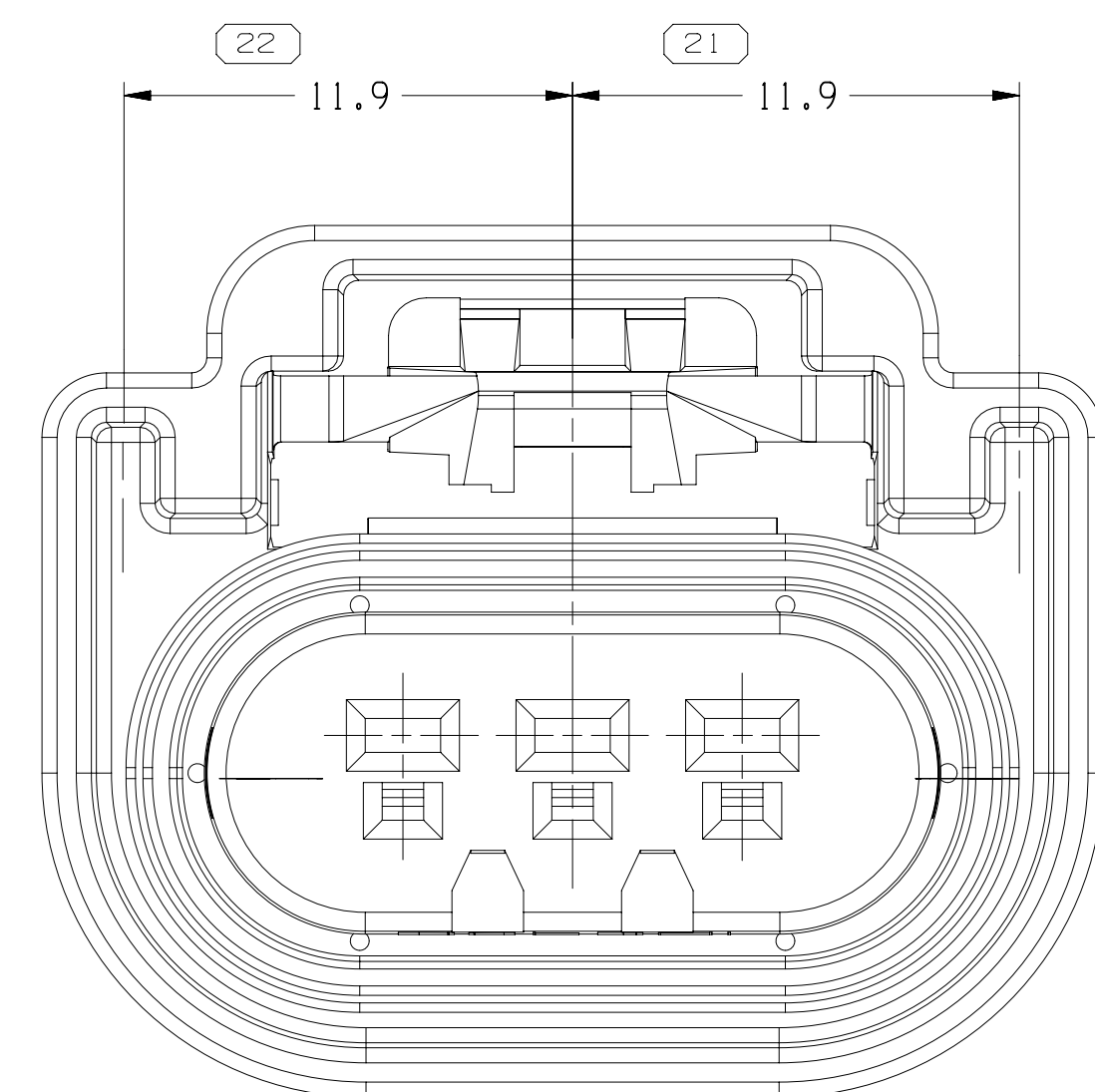

TYPE 103
SAME AS TYPE 102
EXCEPT AS SHOWN

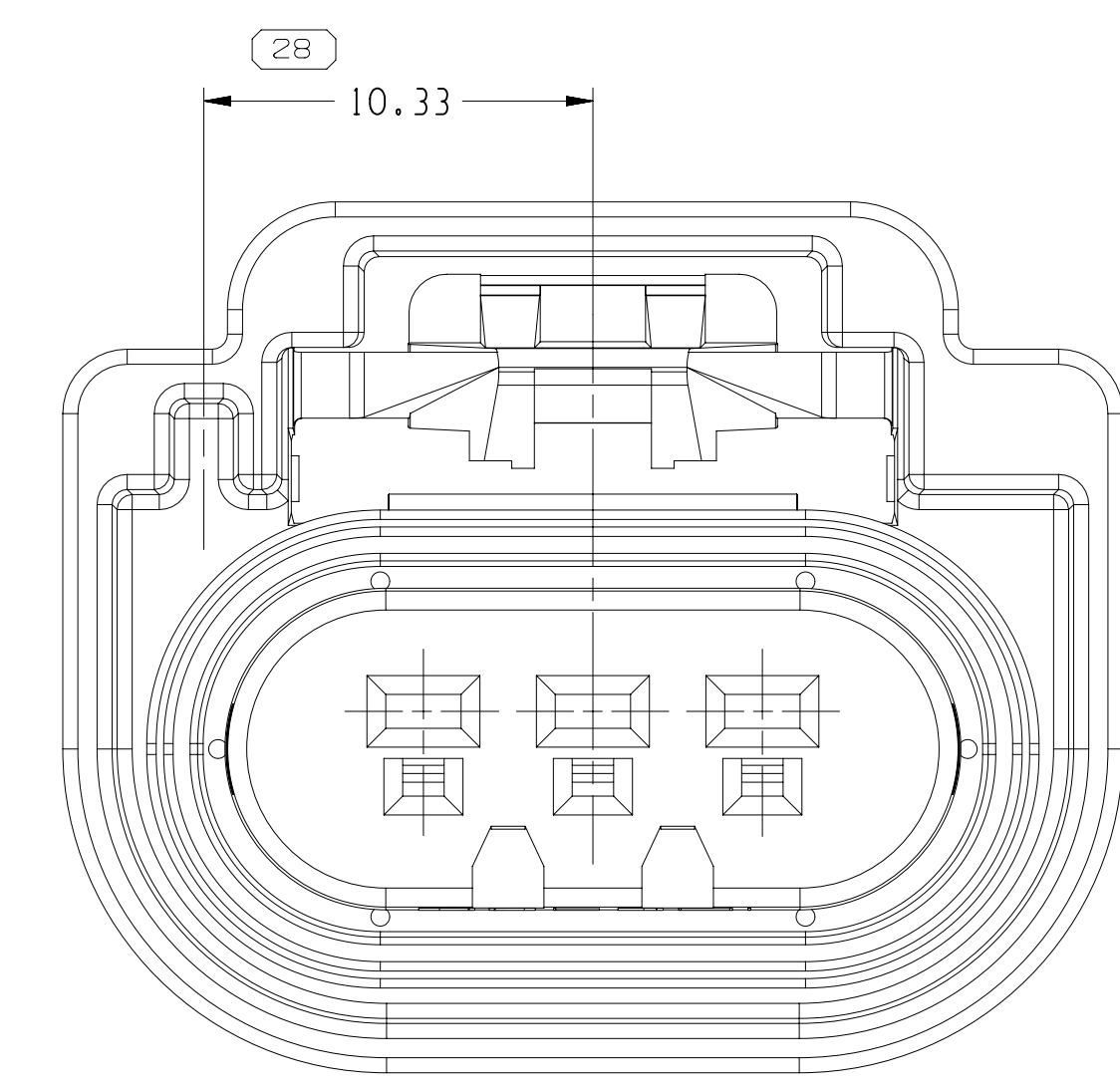

TYPE 108
SAME AS TYPE 102
EXCEPT AS SHOWN

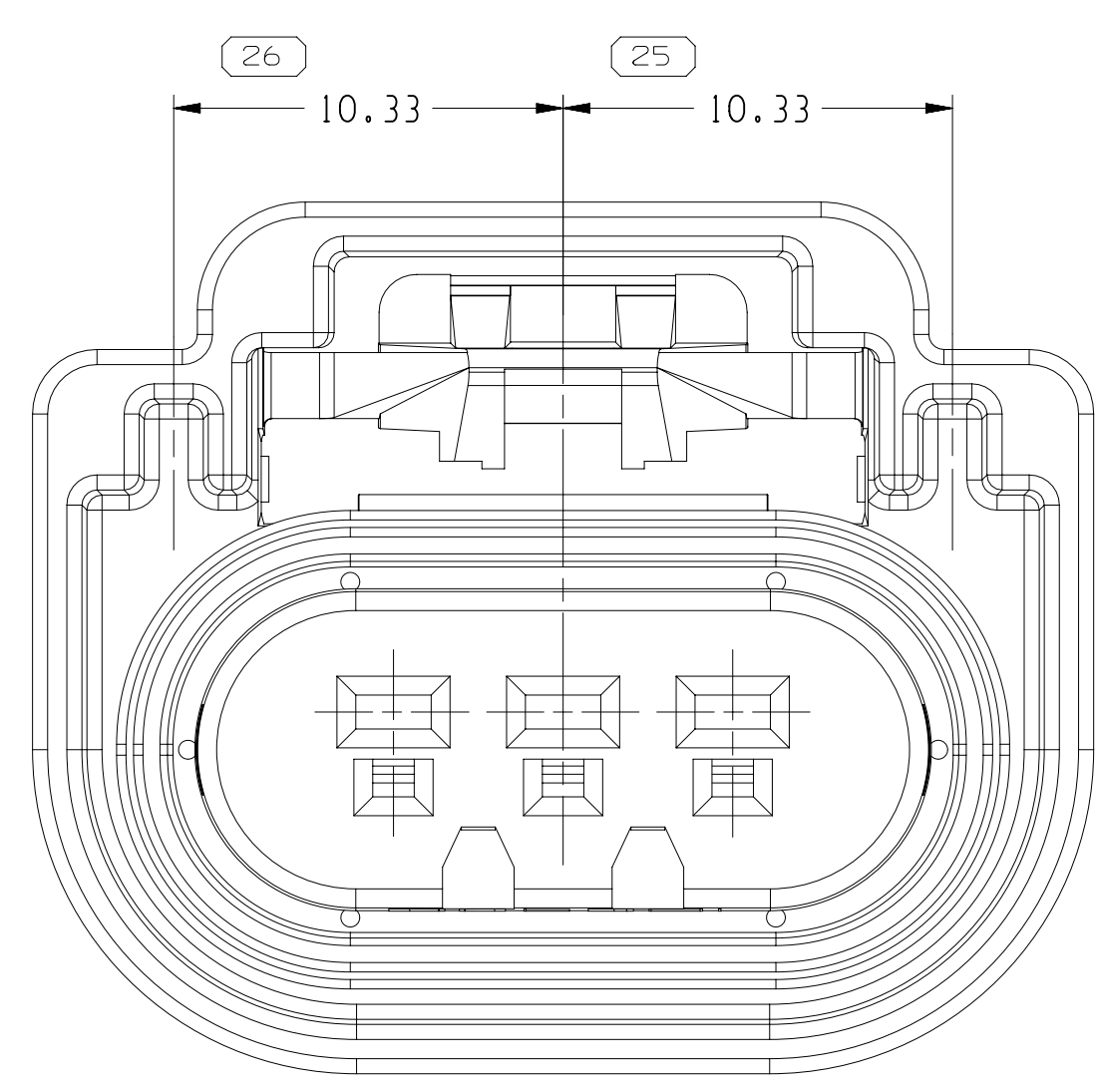

TYPE 105
SAME AS TYPE 102
EXCEPT AS SHOWN

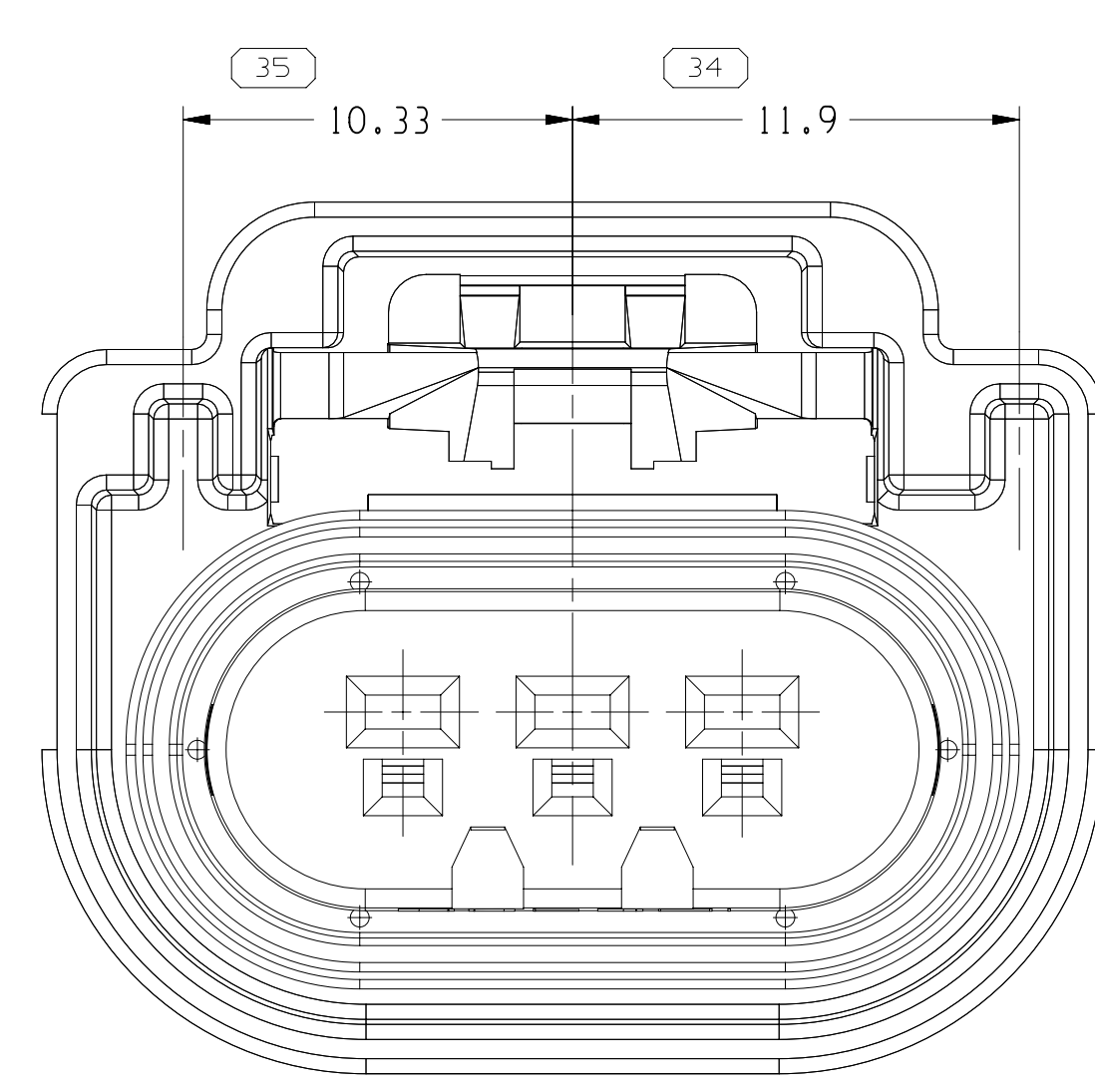

TYPE 102
SAME AS TYPE 101
EXCEPT MATL SPEC CALLOUT (SEE CHART)
AND CAVITY IDENTIFICATION

DRAWING NUMBER		13511997	
SIZE	SCALE	FRAME NO	SHEET NO
A1x3	5:1	2 OF 2	1 OF 3 R 14

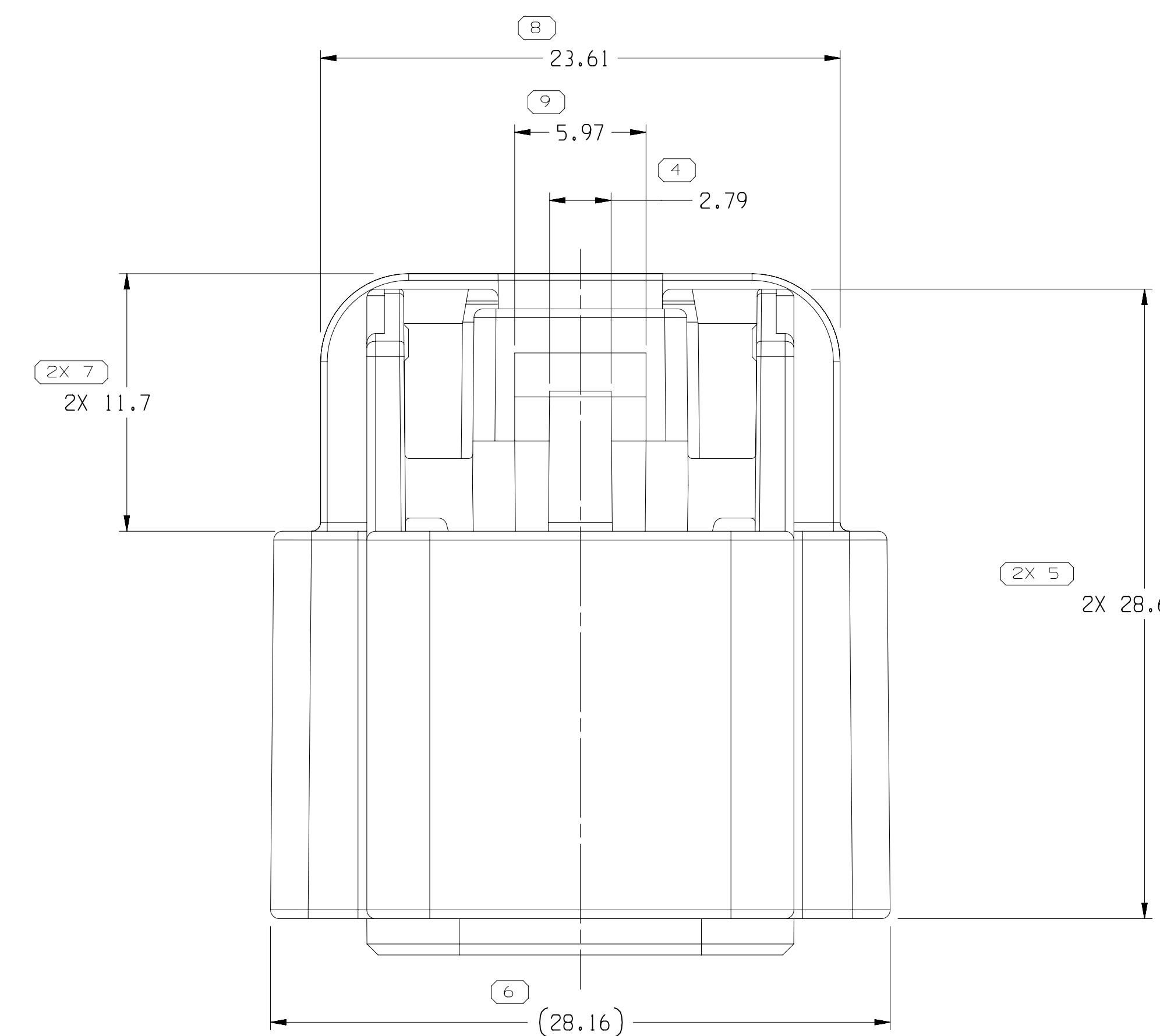

TYPE 101

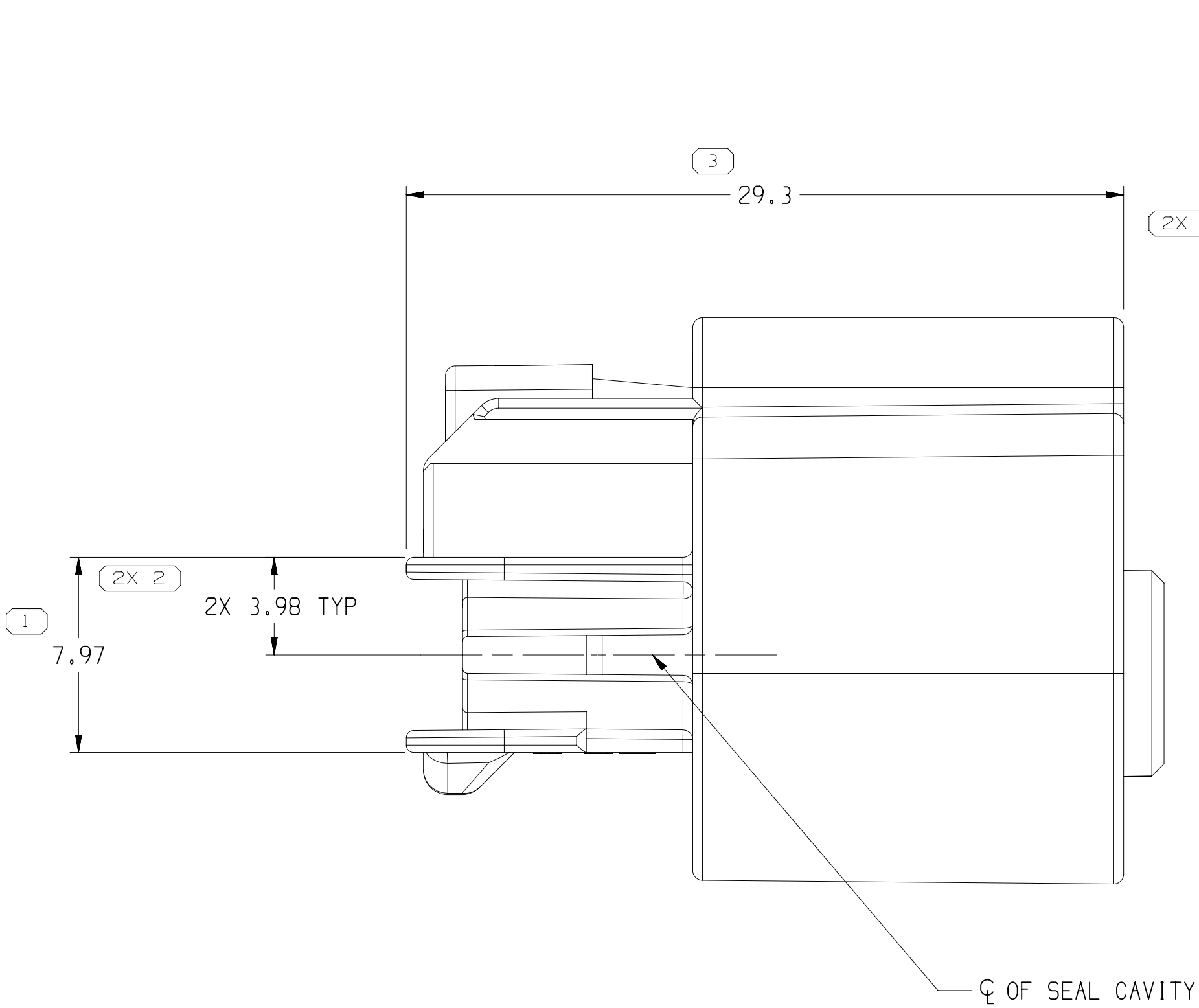

TYPE 101

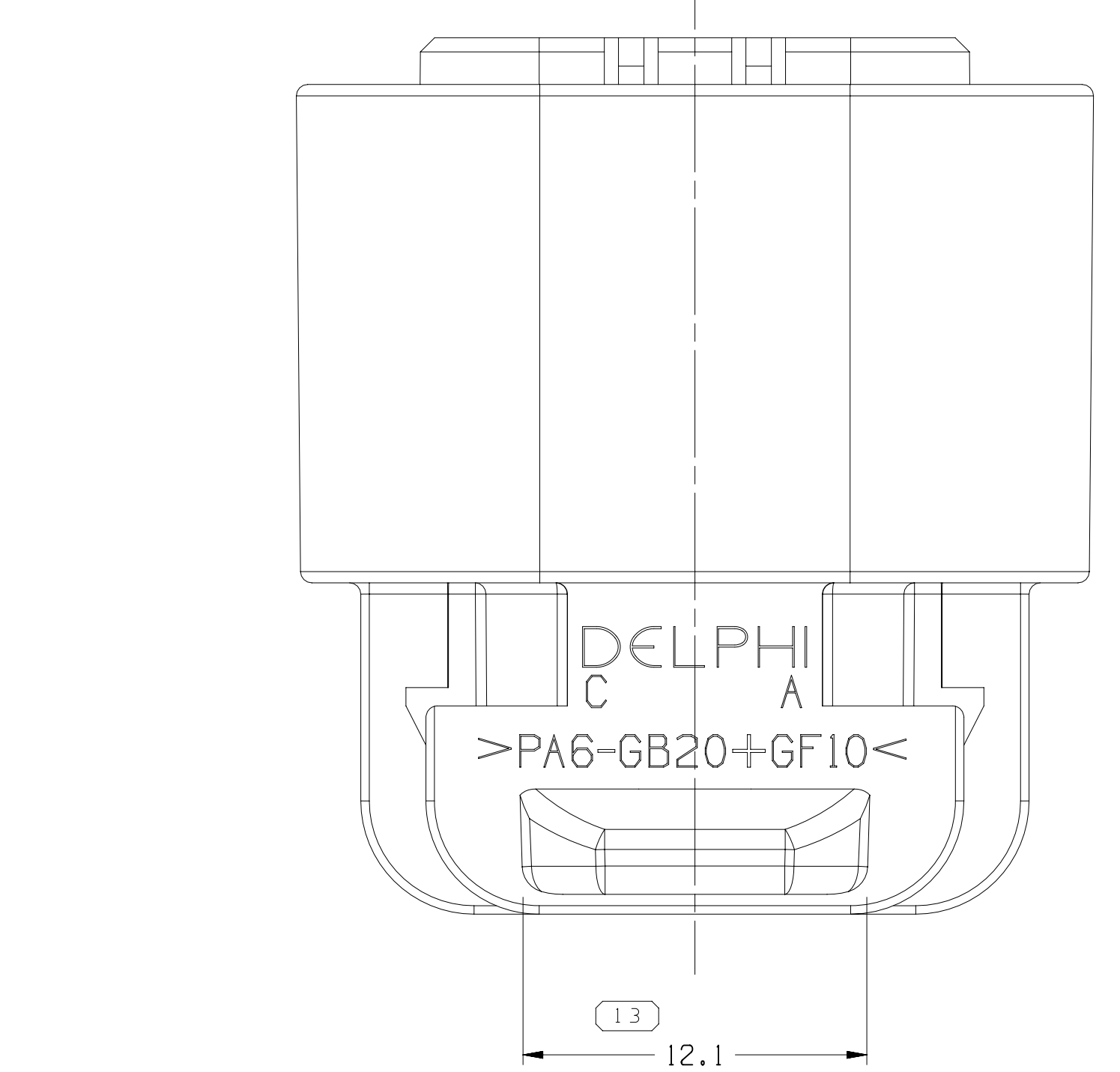

TYPE 101

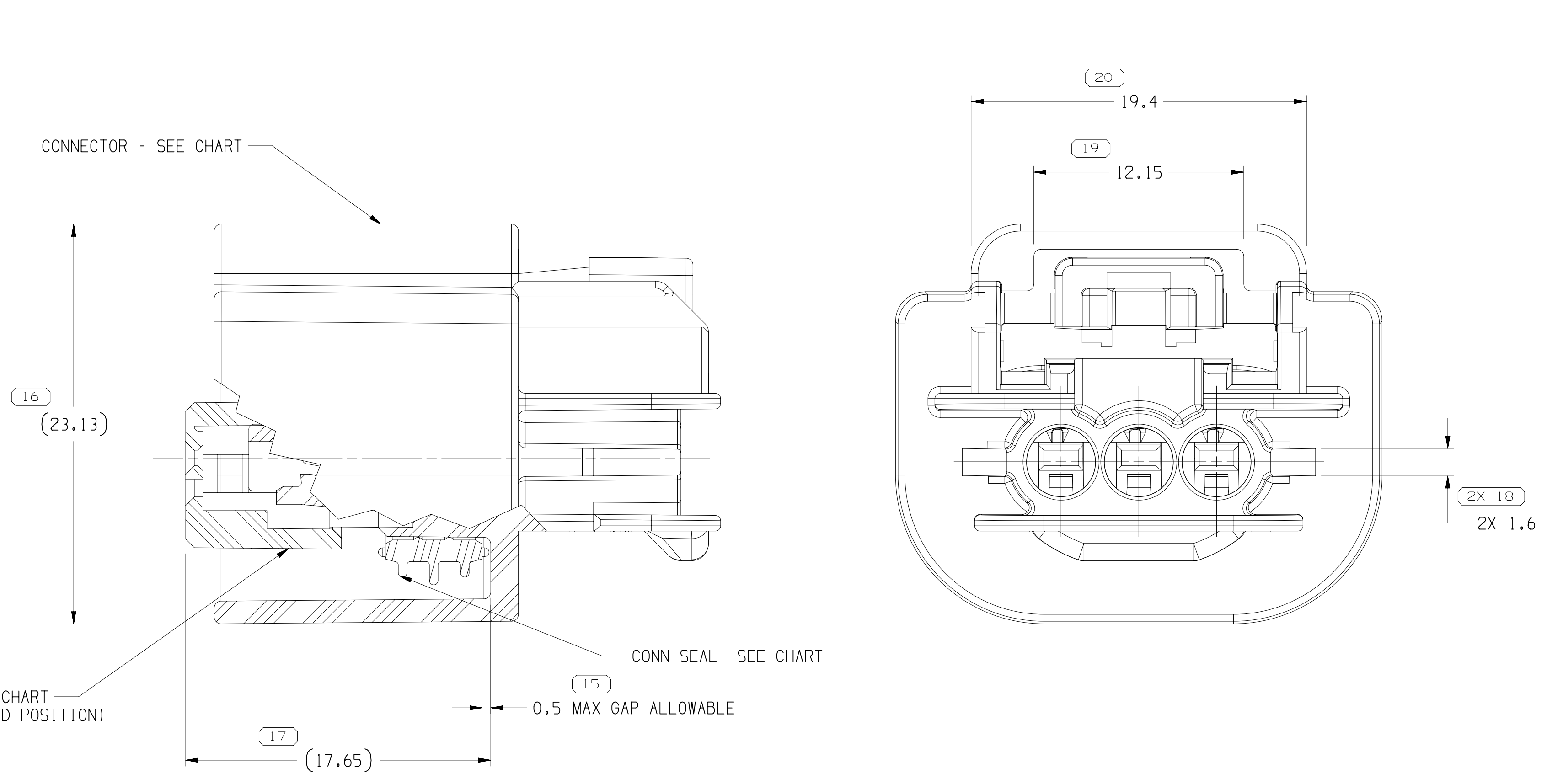
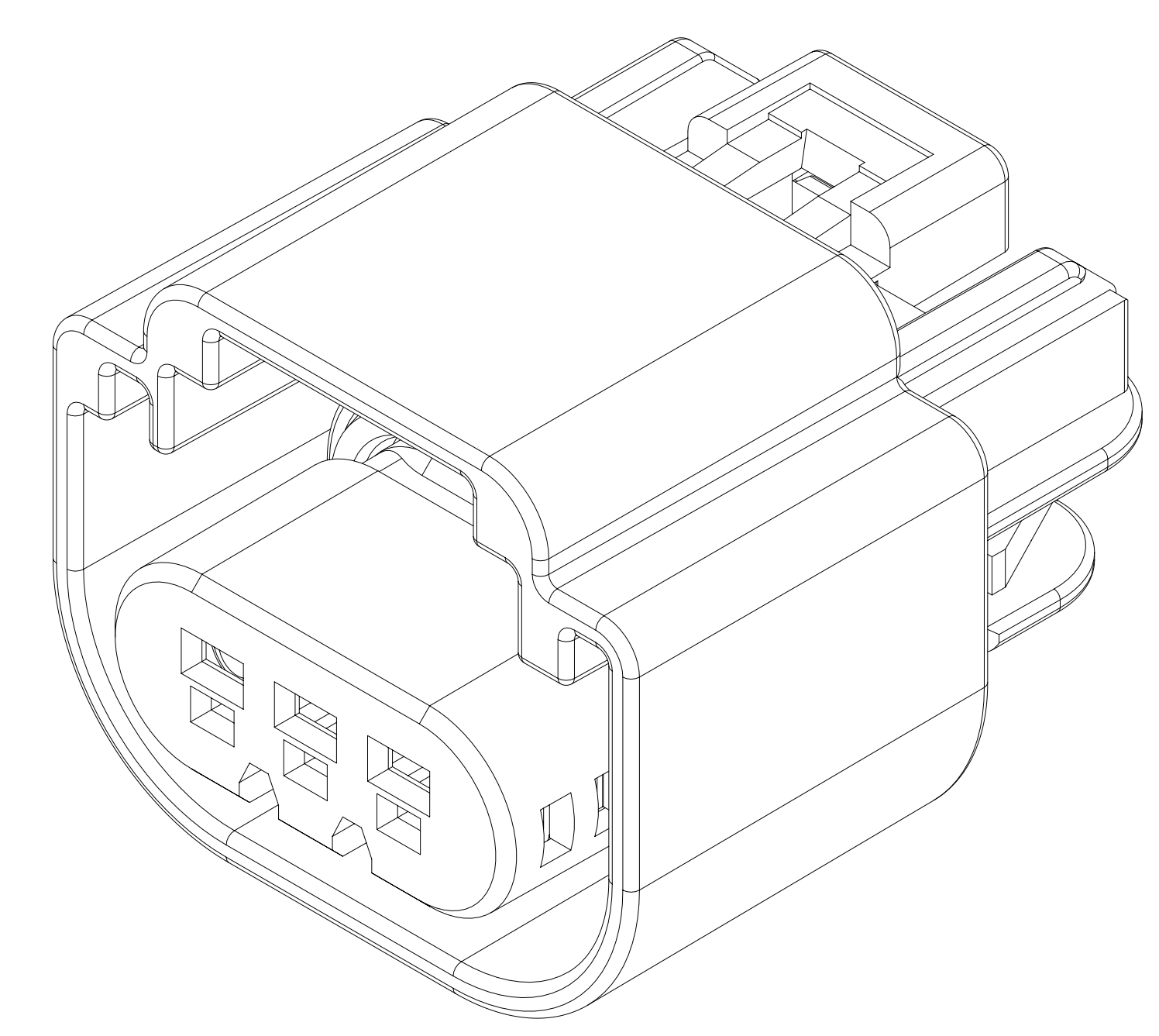

NOTES

- UNLESS OTHERWISE SPECIFIED AND/OR INDICATED: DIMENSIONS ARE TO FACE OF VIEW SHOWN AND AUTOMATICALLY ROUNDED BY COMPUTER FOR INSPECTION (SEE MATH MODEL FOR PRECISE DIMENSIONS). FOR ALL OTHER DIMENSIONS NOT SHOWN BUT REQUIRED FOR TOOL BUILD, SEE MATH MODEL FOR PRECISE TOOL PATH DATA.
- THIS PRODUCT IS NOT CATEGORIZED AS AN APPEARANCE ITEM, MINOR IMPERFECTIONS INCLUDING, BUT NOT LIMITED TO, FLOW MARKS, COLOR BLEMISHES, GATE VESTIGE AND SOFT FLASH THAT DO NOT AFFECT THE FIT, FORM, OR FUNCTION OF THE PART ARE PERMISSIBLE PER DRNP-4.7-CS-01.
- THIS PART IS NOT CONTROLLED FOR AUTOMATIC FEEDING.
- FOR APPLICATION DATA SEE THE INDIVIDUAL APPLICATION DRAWINGS.
- SEALING CODE TBD
- THIS CONNECTOR MEETS OR EXCEEDS SAE/USCAR-2 REV 4, TERMINAL DISENGAGE CRITERIA WITH THE APPLICATION OF A TERMINAL POSITION ASSURANCE (TPA) SECONDARY LOCK.

PART NO	REV	N/P	RESTRICTED USAGE	REPLACED BY	TYPE	CONNECTOR	MATERIAL	RECYCLING CODE	PLR	CONN SEAL
13956363	01	--				108	13955983	PLAS PBT GF20	15326810	15326811
13863707	01	--				102	13863706	PLAS PBT GF20	15326810	15326811
15355377	02	AL	RESTRICTED	13511995		110	15355376	PLAS PA6 GB20+GF10 HS	15326810	15326811
13511995	01	AE				109	13511994	PLAS PBT GF20	15326810	15326811
13511136	01	AE				108	13511130	PLAS PBT GF20	15326810	15326811
13511135	01	AE				107	13511129	PLAS PBT GF20	15326810	15326811
13511134	01	AE				106	13511128	PLAS PBT GF20	15326810	15326811
13511133	01	AE				105	13511127	PLAS PBT GF20	15326810	15326811
13511132	01	AF				104	13511126	PLAS PBT GF20	15326810	15326811
13511131	01	AF				103	13511125	PLAS PBT GF20	15326810	15326811
13511996	01	AF				102	13509896	PLAS PBT GF20	15326810	15326811
15422250	01	AL	RESTRICTED	13511996		101	15419369	PLAS PA6 GB20+GF10 HS	15326810	15326811

PLR - SEE CHART (PRE-STAGED POSITION)

CONN SEAL - SEE CHART

0.5 MAX GAP ALLOWABLE

PLR - SEE CHART (PRE-STAGED POSITION)

CONN SEAL - SEE CHART

0.5 MAX GAP ALLOWABLE

PLR - SEE CHART (PRE-STAGED POSITION)

CONN SEAL - SEE CHART

0.5 MAX GAP ALLOWABLE

PLR - SEE CHART (PRE-STAGED POSITION)

CONN SEAL - SEE CHART

0.5 MAX GAP ALLOWABLE

PLR - SEE CHART (PRE-STAGED POSITION)

CONN SEAL - SEE CHART

0.5 MAX GAP ALLOWABLE

PLR - SEE CHART (PRE-STAGED POSITION)

CONN SEAL - SEE CHART

0.5 MAX GAP ALLOWABLE

PLR - SEE CHART (PRE-STAGED POSITION)

CONN SEAL - SEE CHART

0.5 MAX GAP ALLOWABLE

PLR - SEE CHART (PRE-STAGED POSITION)

CONN SEAL - SEE CHART

0.5 MAX GAP ALLOWABLE

PLR - SEE CHART (PRE-STAGED POSITION)

CONN SEAL - SEE CHART

0.5 MAX GAP ALLOWABLE

PLR - SEE CHART (PRE-STAGED POSITION)

CONN SEAL - SEE CHART

0.5 MAX GAP ALLOWABLE

PLR - SEE CHART (PRE-STAGED POSITION)

CONN SEAL - SEE CHART

0.5 MAX GAP ALLOWABLE

PLR - SEE CHART (PRE-STAGED POSITION)

CONN SEAL - SEE CHART

0.5 MAX GAP ALLOWABLE

PLR - SEE CHART (PRE-STAGED POSITION)

CONN SEAL - SEE CHART

0.5 MAX GAP ALLOWABLE

PLR - SEE CHART (PRE-STAGED POSITION)

CONN SEAL - SEE CHART

0.5 MAX GAP ALLOWABLE

PLR - SEE CHART (PRE-STAGED POSITION)

CONN SEAL - SEE CHART

0.5 MAX GAP ALLOWABLE

PLR - SEE CHART (PRE-STAGED POSITION)

CONN SEAL - SEE CHART

0.5 MAX GAP ALLOWABLE

PLR - SEE CHART (PRE-STAGED POSITION)

CONN SEAL - SEE CHART

0.5 MAX GAP ALLOWABLE

PLR - SEE CHART (PRE-STAGED POSITION)

CONN SEAL - SEE CHART

0.5 MAX GAP ALLOWABLE

PLR - SEE CHART (PRE-STAGED POSITION)

CONN SEAL - SEE CHART

0.5 MAX GAP ALLOWABLE

PLR - SEE CHART (PRE-STAGED POSITION)

CONN SEAL - SEE CHART

0.5 MAX GAP ALLOWABLE

PLR - SEE CHART (PRE-STAGED POSITION)

CONN SEAL - SEE CHART

0.5 MAX GAP ALLOWABLE

PLR - SEE CHART (PRE-STAGED POSITION)

CONN SEAL - SEE CHART

0.5 MAX GAP ALLOWABLE

PLR - SEE CHART (PRE-STAGED POSITION)

CONN SEAL - SEE CHART

0.5 MAX GAP ALLOWABLE

PLR - SEE CHART (PRE-STAGED POSITION)

CONN SEAL - SEE CHART

0.5 MAX GAP ALLOWABLE

PLR - SEE CHART (PRE-STAGED POSITION)

CONN SEAL - SEE CHART

0.5 MAX GAP ALLOWABLE

PLR - SEE CHART (PRE-STAGED POSITION)

CONN SEAL - SEE CHART

0.5 MAX GAP ALLOWABLE

PLR - SEE CHART (PRE-STAGED POSITION)

CONN SEAL - SEE CHART

0.5 MAX GAP ALLOWABLE

PLR - SEE CHART (PRE-STAGED POSITION)

CONN SEAL - SEE CHART

0.5 MAX GAP ALLOWABLE

PLR - SEE CHART (PRE-STAGED POSITION)

CONN SEAL - SEE CHART

0.5 MAX GAP ALLOWABLE

PLR - SEE CHART (PRE-STAGED POSITION)

CONN SEAL - SEE CHART

0.5 MAX GAP ALLOWABLE

PLR - SEE CHART (PRE-STAGED POSITION)

CONN SEAL - SEE CHART

0.5 MAX GAP ALLOWABLE

PLR - SEE CHART (PRE-STAGED POSITION)

CONN SEAL - SEE CHART

0.5 MAX GAP ALLOWABLE

PLR - SEE CHART (PRE-STAGED POSITION)

CONN SEAL - SEE CHART

0.5 MAX GAP ALLOWABLE

PLR - SEE CHART (PRE-STAGED POSITION)

CONN SEAL - SEE CHART

0.5 MAX GAP ALLOWABLE

PLR - SEE CHART (PRE-STAGED POSITION)

CONN SEAL - SEE CHART

0.5 MAX GAP ALLOWABLE

PLR - SEE CHART (PRE-STAGED POSITION)

CONN SEAL - SEE CHART

0.5 MAX GAP ALLOWABLE

PLR - SEE CHART (PRE-STAGED POSITION)

CONN SEAL - SEE CHART

0.5 MAX GAP ALLOWABLE

PLR - SEE CHART (PRE-STAGED POSITION)

CONN SEAL - SEE CHART

0.5 MAX GAP ALLOWABLE

PLR - SEE CHART (PRE-STAGED POSITION)

CONN SEAL - SEE CHART

0.5 MAX GAP ALLOWABLE

PLR - SEE CHART (PRE-STAGED POSITION)

CONN SEAL - SEE CHART

0.5 MAX GAP ALLOWABLE

PLR - SEE CHART (PRE-STAGED POSITION)

CONN SEAL - SEE CHART

0.5 MAX GAP ALLOWABLE

PLR - SEE CHART (PRE-STAGED POSITION)

CONN SEAL - SEE CHART

0.5 MAX GAP ALLOWABLE

PLR - SEE CHART (PRE-STAGED POSITION)

CONN SEAL - SEE CHART

0.5 MAX GAP ALLOWABLE

PLR - SEE CHART (PRE-STAGED POSITION)

CONN SEAL - SEE CHART

0.5 MAX GAP ALLOWABLE

PLR - SEE CHART (PRE-STAGED POSITION)

CONN SEAL - SEE CHART

0.5 MAX GAP ALLOWABLE

PLR - SEE CHART (PRE-STAGED POSITION)

CONN SEAL - SEE CHART

0.5 MAX GAP ALLOWABLE

PLR - SEE CHART (PRE-STAGED POSITION)

CONN SEAL - SEE CHART

0.5 MAX GAP ALLOWABLE

PLR - SEE CHART (PRE-STAGED POSITION)

CONN SEAL - SEE CHART

0.5 MAX GAP ALLOWABLE

PLR - SEE CHART (PRE-STAGED POSITION)

CONN SEAL - SEE CHART

0.5 MAX GAP ALLOWABLE

PLR - SEE CHART (PRE-STAGED POSITION)

CONN SEAL - SEE CHART

0.5 MAX GAP ALLOWABLE

PLR - SEE CHART (PRE-STAGED POSITION)

CONN SEAL - SEE CHART

0.5 MAX GAP ALLOWABLE

PLR - SEE CHART (PRE-STAGED POSITION)

CONN SEAL - SEE CHART

0.5 MAX GAP ALLOWABLE

PLR - SEE CHART (PRE-STAGED POSITION)

CONN SEAL - SEE CHART

0.5 MAX GAP ALLOWABLE

PLR - SEE CHART (PRE-STAGED POSITION)

CONN SEAL - SEE CHART

0.5 MAX GAP ALLOWABLE

PLR - SEE CHART (PRE-STAGED POSITION)

CONN SEAL - SEE CHART

0.5 MAX GAP ALLOWABLE

PLR - SEE CHART (PRE-STAGED POSITION)

CONN SEAL - SEE CHART

0.5 MAX GAP ALLOWABLE

PLR - SEE CHART (PRE-STAGED POSITION)

CONN SEAL - SEE CHART

0.5 MAX GAP ALLOWABLE

PLR - SEE CHART (PRE-STAGED POSITION)

CONN SEAL - SEE CHART

0.5 MAX GAP ALLOWABLE

PLR - SEE CHART (PRE-STAGED POSITION)

CONN SEAL - SEE CHART

0.5 MAX GAP ALLOWABLE

PLR - SEE CHART (PRE-STAGED POSITION)

CONN SEAL - SEE CHART

0.5 MAX GAP ALLOWABLE

PLR - SEE CHART (PRE-STAGED POSITION)

CONN SEAL - SEE CHART

0.5 MAX GAP ALLOWABLE

PLR - SEE CHART (PRE-STAGED POSITION)

CONN SEAL - SEE CHART

0.5 MAX GAP ALLOWABLE

PLR - SEE CHART (PRE-STAGED POSITION)

CONN SEAL - SEE CHART

0.5 MAX GAP ALLOWABLE

PLR - SEE CHART (PRE-STAGED POSITION)

CONN SEAL - SEE CHART

0.5 MAX GAP ALLOWABLE

SYMBOL DEFINITION		TOTAL NO OF INSPECTIONS REQUIRED	
A DIMENSION WITHOUT AN INSPECTION REPORT SYMBOL () DOES NOT REQUIRE INSPECTION. IT MAY BE CONTROLLED ON THE INDIVIDUAL COMPONENT DRAWING.		18	
	LAST NO. USED	18	

MISSING SYMBOLS		NO MISSING SYMBOL NUMBER	
DATE	STG	REV	N/P
30JL02	R	01	-
12SE03	R	02	-
17SE03	R	03	-
24CC03	R	04	-
16AU04	R	05	-
16MY05	R	06	-
05NO08	R	07	-
16MR10	R	08	-
04AU10	R	09	-
30SE10	R	10	-
23MY11	R	11	-

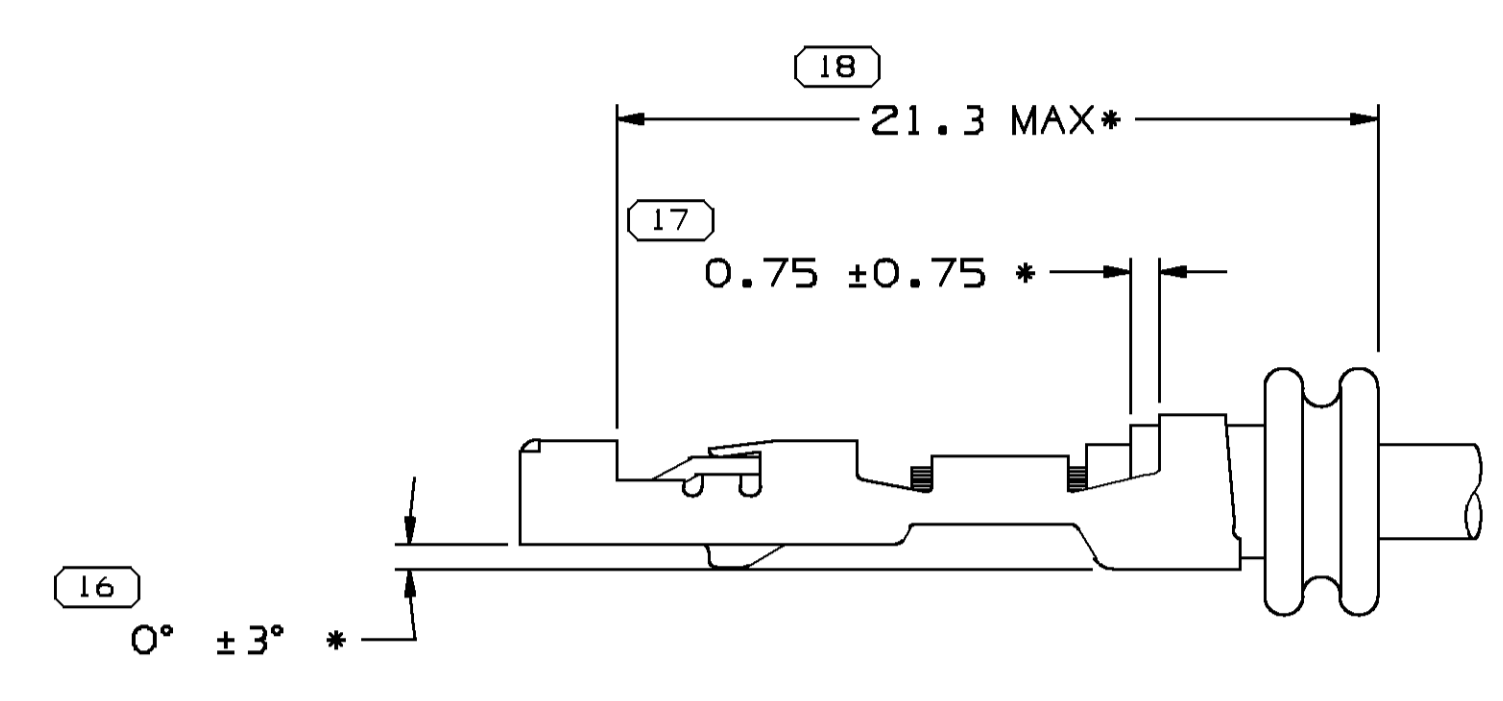
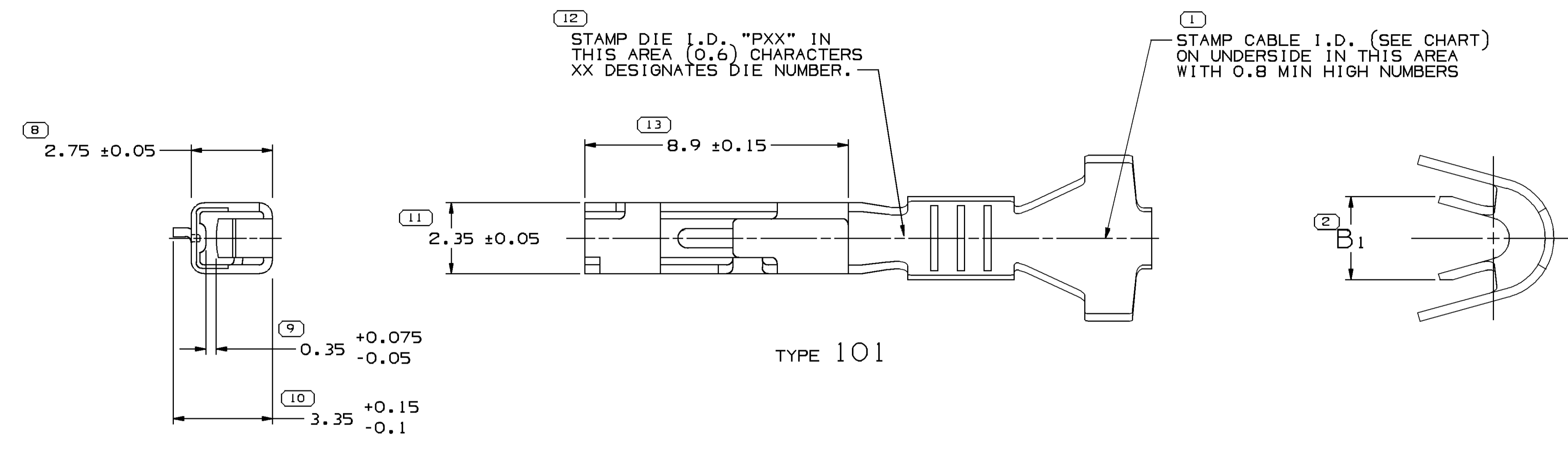

2 RIB SEAL POSITION REF AND TERMINAL/CABLE ALIGNMENT
SCALE 5:1

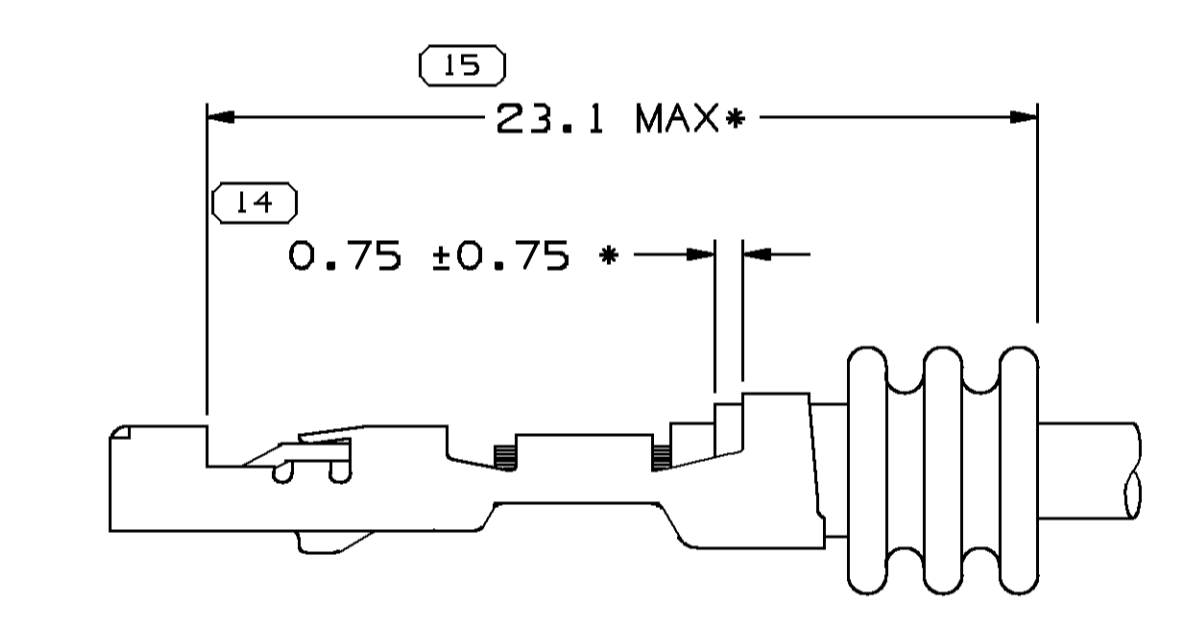
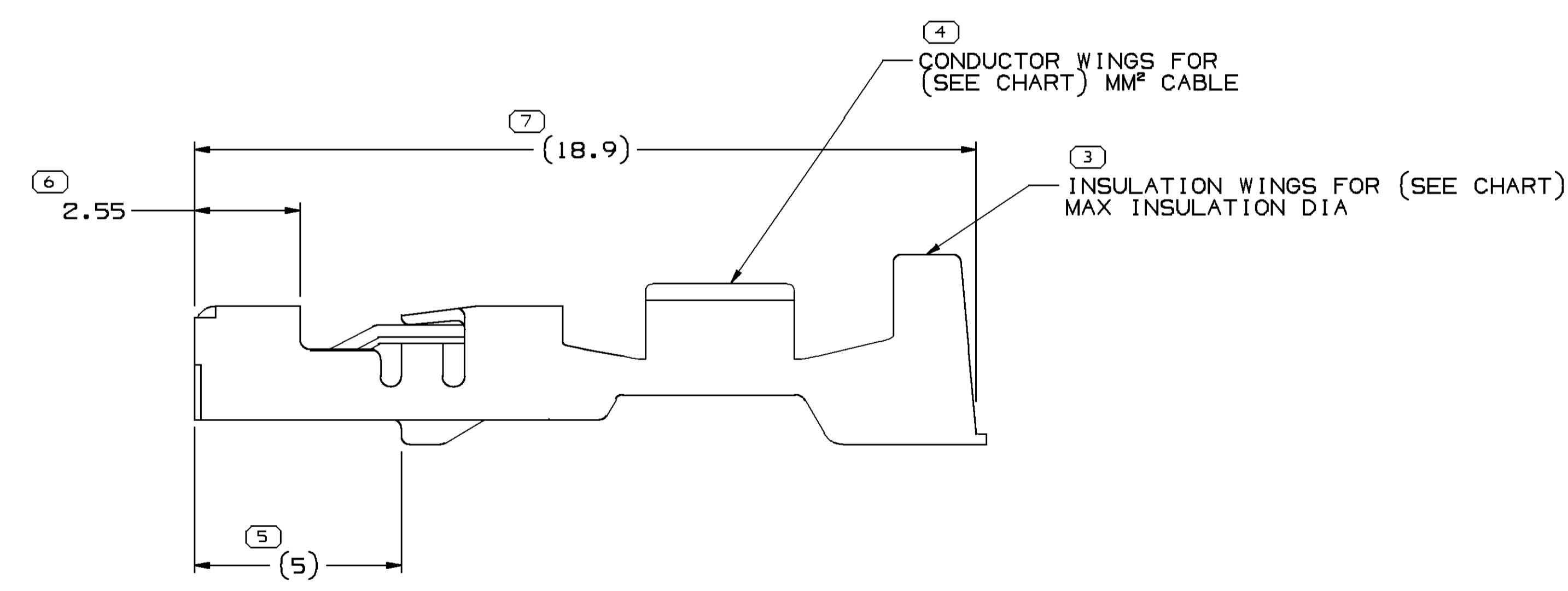

3 RIB SEAL POSITION REF
SCALE 5:1

NOTES

- UNLESS OTHERWISE SPECIFIED AND/OR INDICATED: DIMENSIONS ARE TO FACE OF VIEW SHOWN AND AUTOMATICALLY ROUNDED BY COMPUTER FOR INSPECTION. (SEE MATH MODEL FOR PRECISE DIMENSIONS.) FOR ALL OTHER DIMENSIONS NOT SHOWN BUT REQUIRED FOR TOOL BUILD, SEE MATH MODEL FOR PRECISE TOOL PATH DATA.
- REFERENCE MATING COMPONENTS OR EQUIVALENT:
TERMINAL - 15304706
- * DENOTES DIMENSIONS MADE AT CUT-OFF AND CRIMP DIE.
- DO NOT PROBE, TEST OR OTHERWISE CONTACT THE INTERIOR REGION (THE SPRING OR ANY MOVING PART) OF THIS TERMINAL. SEVERE DAMAGE CAN OCCUR, COMPROMISING THE PERFORMANCE OF THE ELECTRICAL INTERFACE.
- PLATING TYPE:
1. REFLOW TIN 1.9-3.3 MICROMETERS THICK WITH A COPPER UNDERPLATE 0.5 MICROMETER TO 1.0 MICROMETER THICK.

PLATING TYPE INFORMATION SHOWN ABOVE IS REFERENCE ONLY. PLATING REQUIREMENTS ARE CONTAINED IN APPLICABLE MATERIAL SPECIFICATION.

PART NO	REV	N/P	STATUS	PREFERRED MAT'L SIZE	ALTERNATIVE MAT'L SIZE	MAT'L DESCRIPTION	SIZE (MM²)	ID	DIA	TYPE	B ₁ ±0.2	APPLICATION	TYPICAL CABLE SEAL OR EQUIVALENT	TYPICAL SEALING CAVITY CONFIGURATION	CONTACT AREA PLATING TYPE (SEE NOTE 5)	CRIMP AREA PLATING TYPE (SEE NOTE 5)
15326267	04	AG	-	0.3 X 26.71	0.3 X 27.38	COPPER ALLOY	0.75 - 0.8	18	2.02 - 1.7	101	2.65	SEALED (MINI)	15305351	3.2 X 4 OVAL	I	I
15326266	04	AG	-	0.3 X 26.71	0.3 X 27.38	COPPER ALLOY	0.35 - 0.5	21	1.85 - 1.2	101	2.1	SEALED (MINI)	15366022	3.2 X 4 OVAL	I	I
15326265	04	AG	-	0.3 X 26.71	0.3 X 27.38	COPPER ALLOY	0.75 - 1	17	2.25 - 1.7	101	2.65	SEALED (GT)	15366060	Ø 4 ROUND	I	I
15326264	04	AG	-	0.3 X 26.71	0.3 X 27.38	COPPER ALLOY	0.35 - 0.5	21	1.85 - 1.2	101	2.1	SEALED (GT)	15366021	Ø 4 ROUND	I	I

PART DRAWING	
DATE	DATE
APV01 H. CASTRILLON	18AP97
APV02 FCO. KOPCA	21AP97
APV03 S.C. HSIEH	30SE98
APV04	
APV05	

DELPHI
DELPHI PACKARD ELECTRICAL/ELECTRONIC ARCHITECTURE
WARREN, OH

OR DATE

APV01 H. CASTRILLON 18AP97
APV02 FCO. KOPCA 21AP97
APV03 S.C. HSIEH 30SE98
APV04
APV05

UNLESS OTHERWISE SPECIFIED THIS DOCUMENT IS IN ACCORDANCE WITH ASME Y14.5M-1994 AS MODIFIED BY THE 2003 SUPPLEMENT AND TELEPHONING ADDENDUM-2001. SEPARATE PATTERNS OF FEATURES MAY BE SHOWN SEPARATELY REGARDLESS OF DATUM REFERENCES.

ALL DIMENSIONS ARE IN MILLIMETERS

REFERENCE

DRAWING NAME
TAXI TERM F 0T 150

DRAWING NUMBER
12191815

SIZE A0 SCALE 10:1 FRAME NO 1 OF 1 SHEET NO 2 OF 2 STG REV N/P R 11 -

PROCESS SENSITIVE DIMENSION	
DIMENSIONS ENCLOSED IN () INDICATE REFERENCE DIMENSIONS AND NO TOLERANCE LIMITS ARE ESTABLISHED	
DIMENSIONAL RANGE (MM)	CHART CD
FROM 0 TO 12	> 12
TOLERANCE UNLESS OTHERWISE SPECIFIED	
±0.1	±0.2
ANGULAR TOLERANCE ±0.2°	

