

M 794953-4



Proseguire nella pagina successiva per visualizzare la scheda tecnica dei componenti

Revisione	Prodotto
REV.02 17/04/2026	AfterMarket

REVISIONS				
P	LTN	DESCRIPTION	DATE	APP'D
D		REVISED PER ECR-25-247601	11OCT2025	PC JH

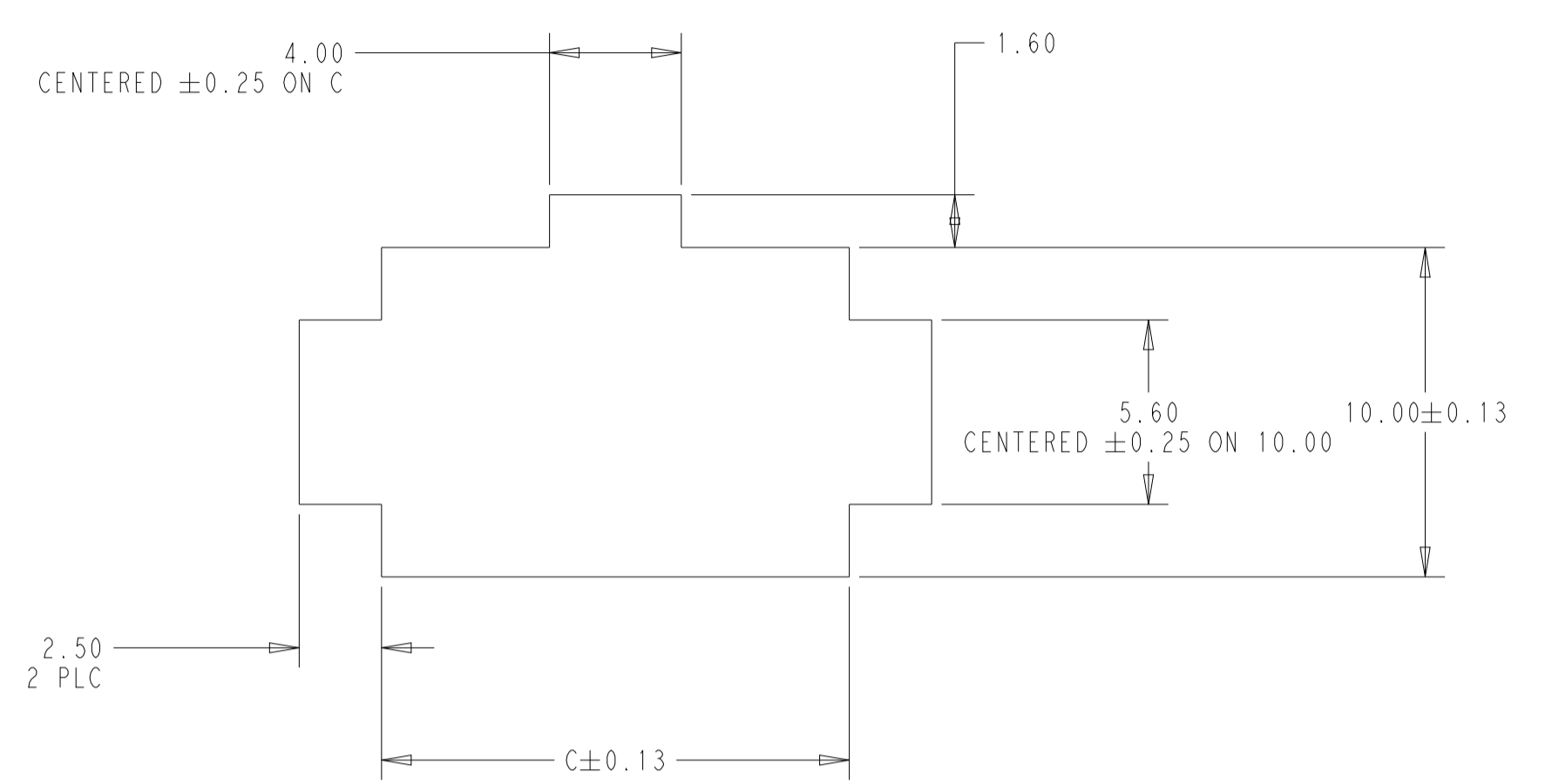
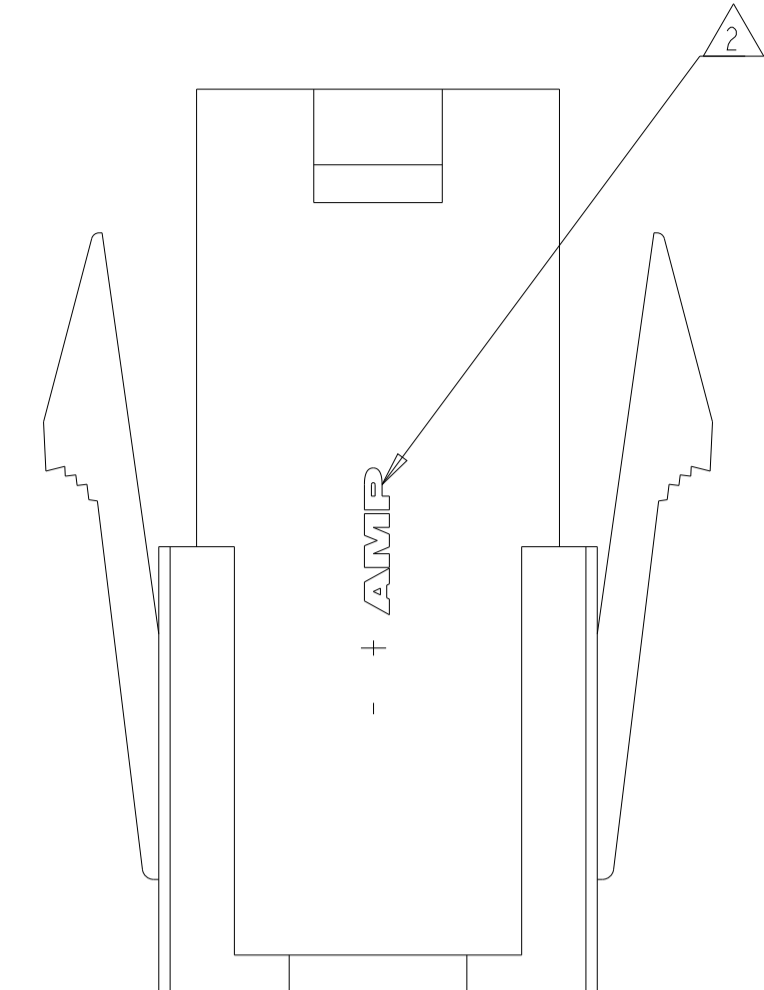
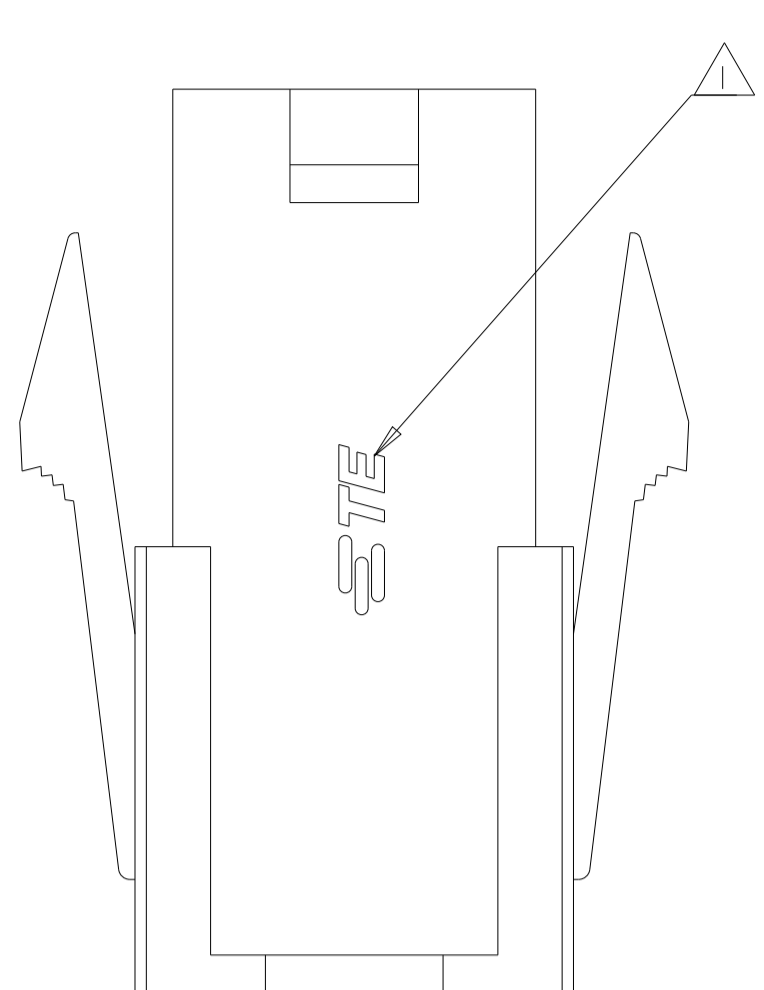

RECOMMENDED CUT OUT FOR 2.00 MAX THICK PANEL

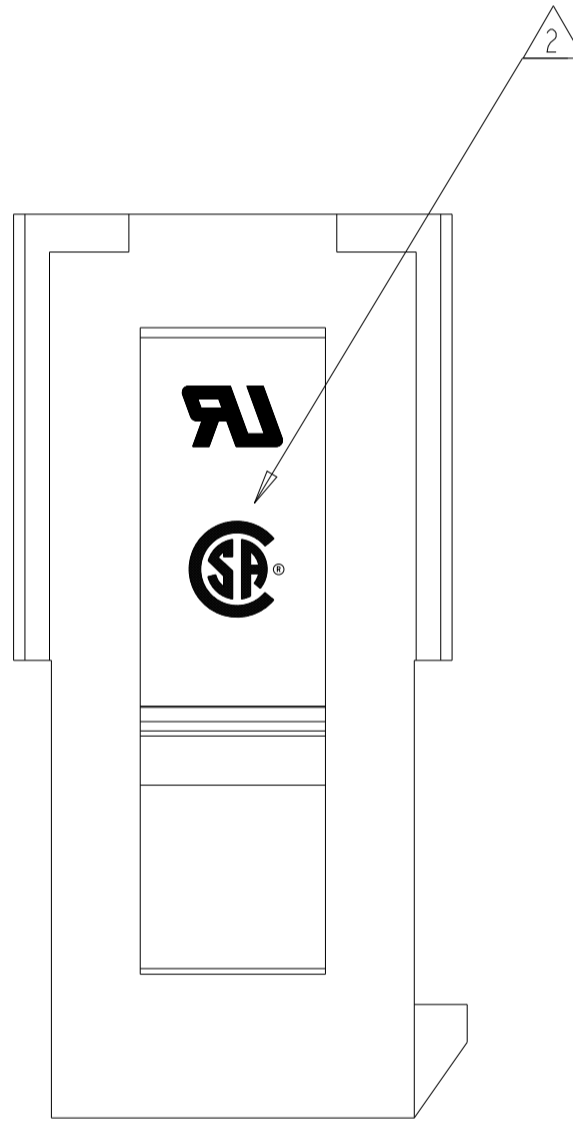
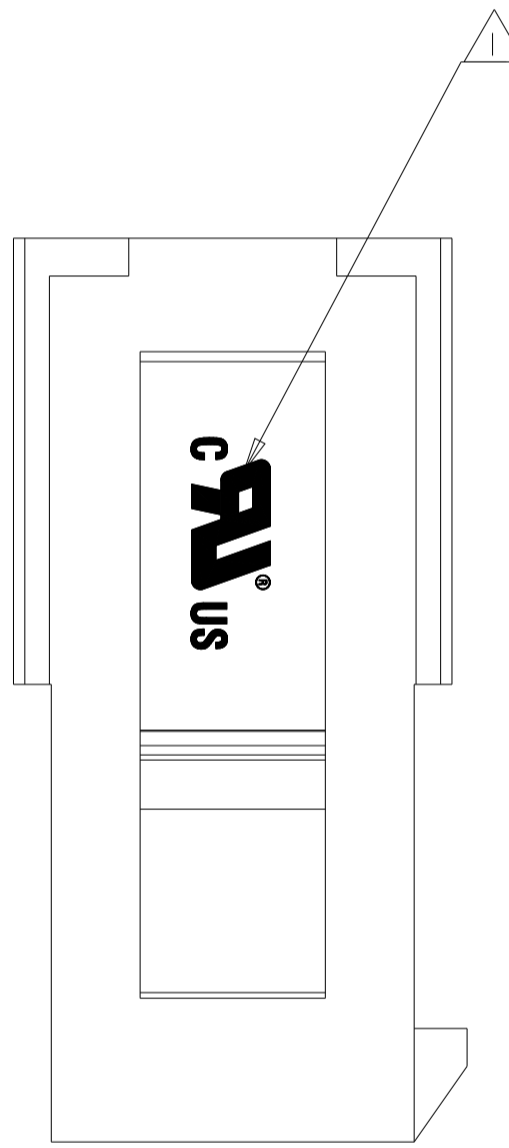
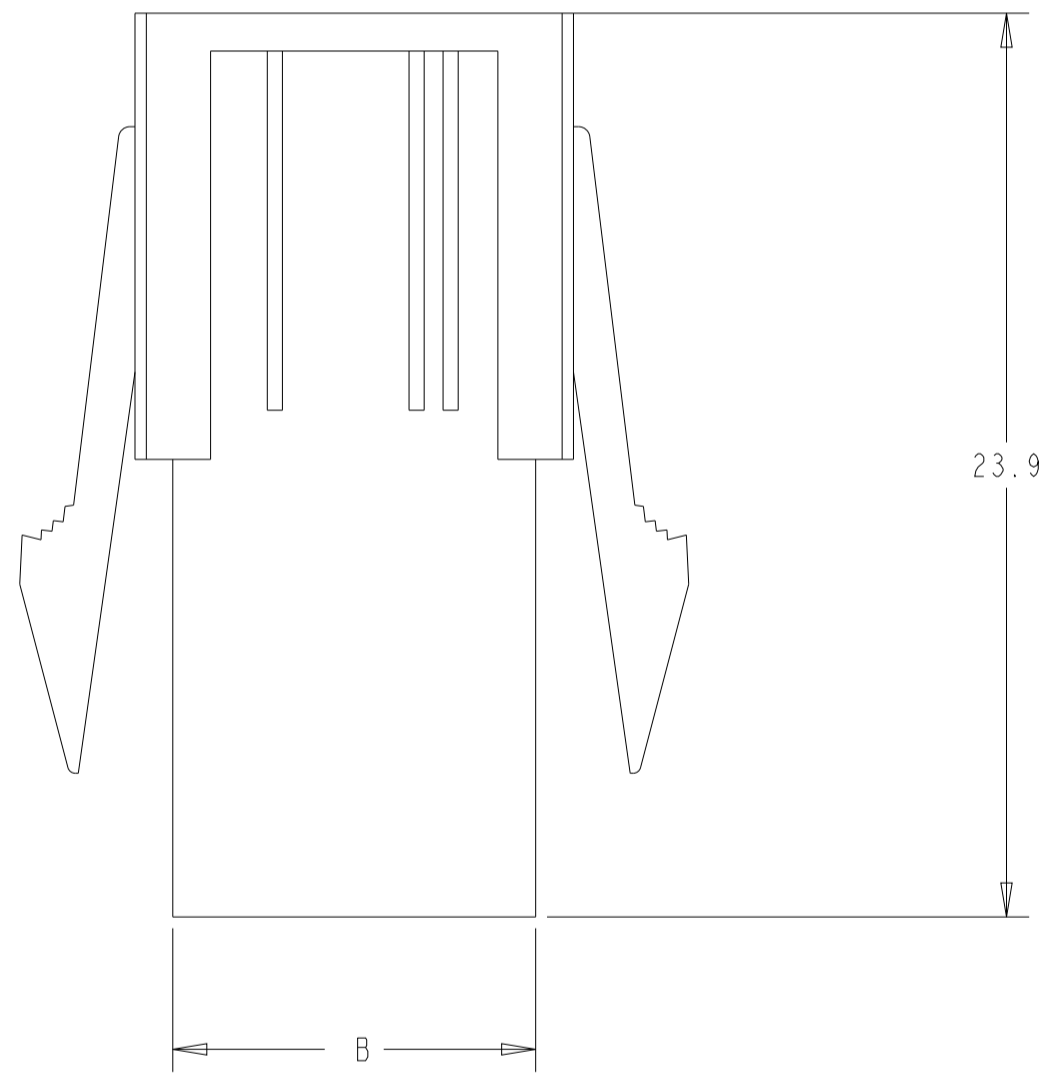
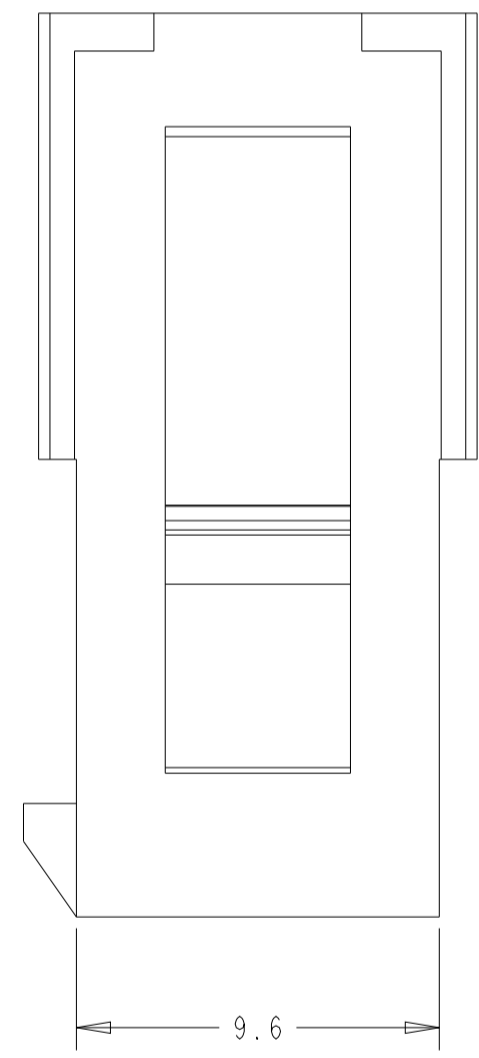
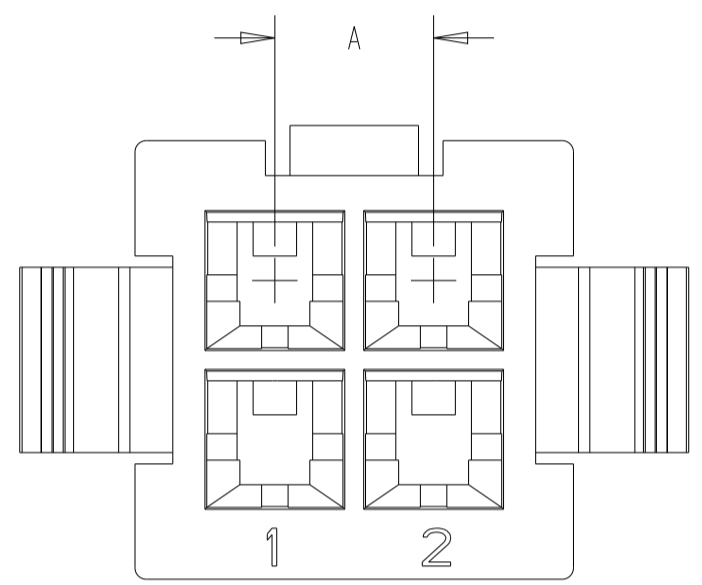

- NOTES:
- 1 TYPE 1
 - 2 TYPE 2
 - 3 MATERIAL: NYLON, UL94V-2 (COLOR-NATURAL, COLOR OF PARTS MAY VARY)
 - 4 PANEL MUST BE PUNCHED SO THAT THE HOUSING ENTERS THE PANEL IN THE SAME DIRECTION AS THE PUNCH

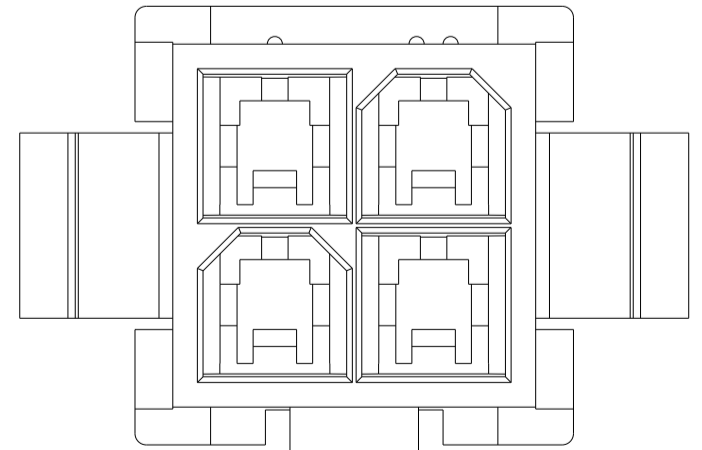

2	52.00	51.60	46.20	24	2-794953-4
2	47.80	47.40	42.00	22	2-794953-2
2	43.60	43.20	37.80	20	2-794953-0
2	39.40	39.00	33.60	18	1-794953-8
2	35.20	34.80	29.40	16	1-794953-6
2	31.00	30.60	25.20	14	1-794953-4
2	26.80	26.40	21.00	12	1-794953-2
2	22.60	22.20	16.80	10	1-794953-0
2	18.40	18.00	12.60	8	794953-8
2	14.20	13.80	8.40	6	794953-6
2	10.00	9.60	4.20	4	794953-4
1	5.80	5.40		2	794953-2
	C	B	A	POS	PART NUMBER

THIS DRAWING IS A CONTROLLED DOCUMENT. DWN P. CHEN 9-6-2025
 CHK J. HUANG 11-6-2025
 DIMENSIONS: mm TOLERANCES UNLESS OTHERWISE SPECIFIED: APVD J. HUANG 11-6-2025
 0 PLC ±0.4
 2 PLC ±0.25
 3 PLC ±0.25
 4 PLC ±0.25
 ANGLES ±3°
 MATERIAL FINISH

NAME Val-U-Lok V2 Plug Housing
 PRODUCT SPEC 108-2112
 APPLICATION SPEC 114-13172
 WEIGHT -
 CUSTOMER DRAWING

TE Connectivity
 SIZE CAGE CODE DRAWING NO RESTRICTED TO
 A 00779 C=794953
 SCALE 5:1 SHEET 1 OF 1 REV D