

FUSIBILI STRIPE HSB PER VW



Specifications

Material: Zinc-alloy
 Connections: Zinc-alloy
 2 x M6 bolts, distance 30 mm
 Starting Torque: 4 Nm +/- 1 Nm

Description

Non-housed fuse strips for rated voltage up to 32 VDC. Current rating 30 A-175 A. Ring type lugs.

Dimensions

Dimensions in mm

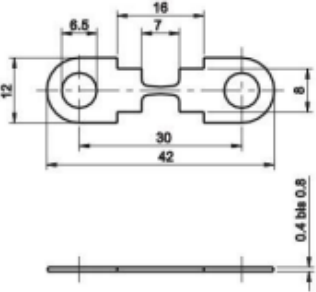

Pre-Arcing Time-Limits

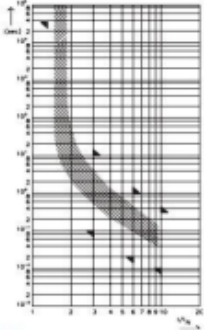

FI = 1.00 (max. operating current: 1.0 x I_{ra} at 23°C)

Time-Current Characteristics

% of Rating	Opening Time Min / Max (s)
100	∞ / -
125	360,000 s / -
300	0.100 s / 10 s
600	0.020 s / 1 s
1000	0.010 s / 0.300 s

Ratings

Current Rating	Typ. Voltage Drop	Cold Resistance	I ² t
30 A	44mV	1.33 mΩ	3800 A ² s
40 A	40mV	0.89 mΩ	11200 A ² s
50 A	44mV	0.72 mΩ	21300 A ² s
60 A	38mV	0.58 mΩ	41400 A ² s
80 A	40mV	0.43 mΩ	44800 A ² s
110 A	40mV	0.31 mΩ	139000 A ² s
150 A	52mV	0.23 mΩ	465000 A ² s
175 A	46mV	0.22 mΩ	560000 A ² s

